

Your cabinetry shelving comes fully height adjustable. To adjust the height of your shelves, please follow the instructions below:

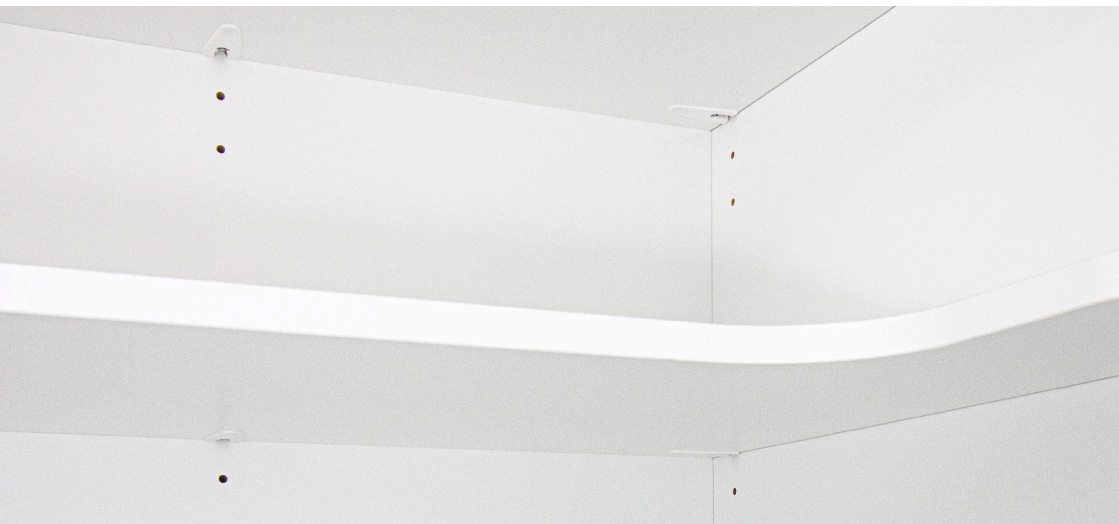

## 1 Loosen the Cam Screw

Use a Phillips head screw driver to loosen and unscrew each cam underneath the shelf. This must be done to each cam on the shelf you are adjusting.

Once all cam screws have been removed, lift to remove the shelf.

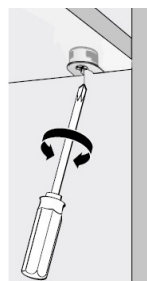

## 2 Move Each Shelf Stud

Once the shelf has been removed, unscrew each shelf stud and move it to your desired height in the pre-cut holes.

Screw each shelf stud back in and place your shelf back in at the new height.

Screw all cam screws back in.

